

Fully Threaded Tapered Cannulated Headless Bone Screw

Engineered with Faceted Threadform Technology



DESIGN MATTERS



Sizes and Indications

Available Screw Sizes

2.2mm	10mm to 40mm
3.0mm	20mm to 50mm
3.5mm	30mm to 60mm
4.5mm	40mm to 70mm

Note: 2.2mm screw increments are 2mm, all others 5mm

Indication

2.2mm 3.0mm 3.5mm 4.5mm

Arthrodesis

Intercarpal Joint	●	●		
Distal Interphalangeal Joint (DIJ/DIP)	●	●	●	
Proximal Interphalangeal Joint (PIP/PIJ)	●	●		
Metacarpophalangeal Joint (MCP)	●	●	●	●

Fractures

Metacarpal	●	●	●	●
Capitellum	●	●		
Proximal Phalanx	●	●		
Scaphoid	●	●		

Non-unions

●	●	●	●
---	---	---	---

Faceted Threaded Screws Require 50% Less Insertion Torque

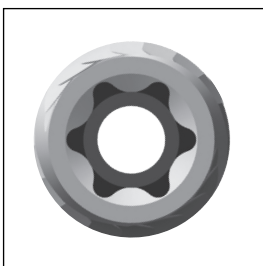

Recessed Torx/hexalobe drive heads for peak torque control and superb engagement

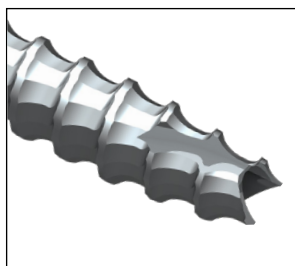

Simplified, precise surgical installation

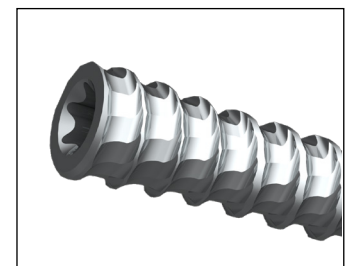

Faceted geometry creates higher pullout strength for better fixation and lower insertion torque

SINGLE USE STERILE KIT

Introducing the Diamond Orthopedic Sterile Kit. Pre-sterilized, for single-use to treat a variety of hand indications. The only sterile kit on the market for use with Diamond Orthopedic's revolutionary faceted threadform technology.

screwdriver

- Single-use instruments
- Individually Boxed
- Double barrier
- Backer card mounted



61% GREATER PULLOUT STRENGTH AT 2 WEEKS

In an in vivo ovine study, the Diamond Orthopedic faceted screw demonstrated 61% greater pullout strength compared to the leading helical screw two weeks after surgery^[A]

0 Weeks Post-Op [N/mm³]



2 Weeks Post-Op [N/mm³]



^[A] Based on in vivo ovine testing conducted at OrthoKinetic Testing Technologies as compared to market leading helical screw with same profile. Additional validation testing has been performed in non-biological substrates. Data on file.

2X TORQUE CONVERSION

Faceted Screw Achieved 2x Compression at 3.5Nm^[B]

- Lower insertion torque reduces risk of bone necrosis
- 2X compression at bone interface versus traditional helical threads

